



EZ50

Tracked Zero Tail Excavator

The compact and powerful zero-tail excavator

Full speed ahead: The EZ50 mini-excavator offers excellent lifting and digging power as well as quick work cycles. Using the newest technologies, the emissions of the mini-excavator were reduced and, at the same time, the efficiency increased. For example, the powerful engine in the EZ50 meets the stage 5 exhaust emission standards. In terms of operator-friendliness, the excavator is impressive. The intuitive operating concept and excellent view of the work area contribute to the easy and comfortable operation of the machine. The EZ50 is also a zero-tail excavator and is well suited for working in narrow spaces.

Highlights

- Flexible cylinder rod protection
- 3-point kinematics
- Active Working Signal (AWS)
- Load Sensing Flow Sharing
- Zero Tail

Technical Data

Hydraulic

Operating pressure hydraulics	3,552.5 psi
Hydraulic pump	Axial piston pump
Flow rate	33.3 gal/mi
Flow rate max.	33.3 gal/mi

Mechanical - Output Details

Travel speed	2.7 m/H
--------------	---------

Mechanical Details

Length	238.2 "
Width	77.2 "
Height	105.0 "
Weight	10,178.75 lb
Operating weight (min.-max.)	10,685.8 - 12,908.1 lb
Digging depth (max.)	144.4 "

Engine

Cooling	Water-cooling
---------	---------------

Engine type	Diesel engine
Cylinder	3.0
Cylinder capacity	101.4 Inch ³
Inclined position max.	30.0 °
Fuel	Diesel EN 590
Effective power	43.6 hp
Nominal Engine speed	2,000.0 1/min
Exhaust-gas limit	EU Stage V
Battery capacity (nom. value)	77.0 Ah
Engine Manufacturer	Perkins
Engine Designation	403J-E17T

Environment Data

Sound power LWA, guaranteed	97.0 dB(A)
-----------------------------	------------

Shipping and Storage

Shipping weight	10,178.8 lb
-----------------	-------------

Dimensions

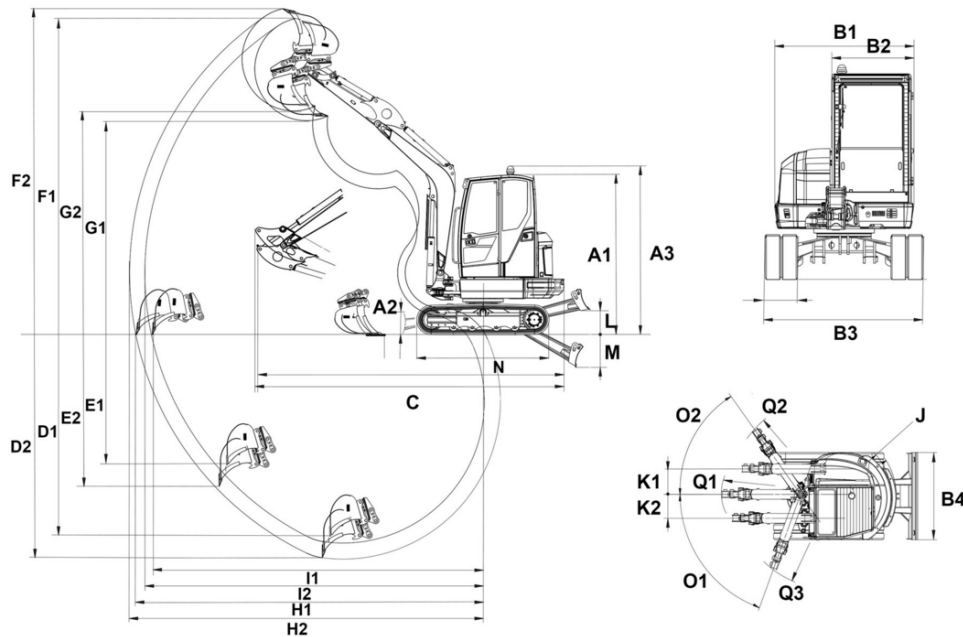

A1	Height with cab	100.67 in
A3	Total height with rotating beacon	105.08 in
B1	Width of upper carriage	67.93 in
B2	Width of cab	38.61 in
B3	Width travel gear	77.22 in
B4	Width of dozer blade	77.22 in
C	Transport length short shovel arm	215.4 in
	Transport length long shovel arm	215.99 in
D1	Digging depth max., short shovel arm	136.6 in
D2	Digging depth max., long shovel arm	144.48 in
E1	Piercing depth max., short shovel arm	82.15 in
E2	Piercing depth max., long shovel arm	89.12 in
F1	Piercing height max., short shovel arm	215.52 in
F2	Piercing height max., long shovel arm	220.6 in
G1	Dumping height max., short shovel arm	144.01 in
G2	Dumping height max., long shovel arm	149.09 in
H1	Digging radius max., short shovel arm	233.09 in
H2	Digging radius max., long shovel arm	242.31 in
I1	Max. reach at ground level (short shovel arm)	228.28 in
I2	Max. reach at ground level (long shovel arm)	235.93 in
J	Tail swing radius	41.25 in
	Tail swing radius with tail weight	45.39 in
K1	Boom offset max. (to center of bucket right side)	30.1 in
K2	Boom offset max. (to center of bucket left side)	30.34 in
L	Stacking height max. (dozer blade above surface)	16.15 in
M	Digging depth max. (dozer blade below surface)	17.45 in
N	Length travel drive	98.82 in
O1	Max. swivel angle (arm system to the left)	70 °
O2	Max. swivel angle (arm system to the right)	55 °
Q1	Boom swing radius center	98.7 in
Q2	Boom swing radius right	91.76 in
Q3	Boom swing radius left	81.32 in
	Distance bucket dozer blade, short shovel arm	16.9 in
	Distance bucket dozer blade, long shovel arm	13.12 in

The illustrations, equipment and data shown may deviate from the current delivery program of your country. Optional equipment subject to additional charge may be shown. Subject to changes.