



## EW65

### Wheeled Excavator

power and speed

With a Wacker Neuson EW65 wheeled excavator, an operator can easily jump in the cab and head to the job site. The machine's road travel mode helps reduce time- and cost-intensive transport, while the variable drive system has a low rate of fuel consumption. With just one pedal to operate, the EW65 drives almost like a car. But it's a highly capable excavator, too. The powerful load-sensing hydraulic system (LUDV) ensures the same speed for several boom movements with different loads. With proportional control auxiliary hydraulics and a triple boom, the EW65 offers smooth work with attachments and an excellent digging range.

### Highlights

- 3-point kinematics
- Intuitive operating concept
- Optimal positioning of hydraulic components
- Powerful drive system with LUDV
- Triple boom

### Technical Data

#### ■ Hydraulic

Operating pressure hydraulics	3,480.0 psi
Flow rate	38.0 gal/mi
Tank capacity	24.3 gal US

#### ■ Mechanical - Output Details

Nominal rotation speed	2,500.0 1/min
Travel speed	18.6 m/H

#### ■ Mechanical Details

Length	250.0 "
Width	82.2 "
Height	109.3 "
Operating weight (min.-max.)	14,892.2 - 19,063.4 lb
Digging depth (max.)	153.3 "

#### ■ Engine

Cooling	Water-cooling
Engine type	Diesel engine
Cylinder	4.0
Cylinder capacity	135.2 Inch3

Inclined position max.	30.0 °
Fuel	HVO EN15940
Effective power	61.0 hp
Nominal Engine speed	3,000.0 1/min
Operating power	61.0 hp
Operating Engine speed	3,000.0 1/min
Maximum torque	140.7 lb/ft
Air cleaner	Dry air filter
Battery capacity (nom. value)	88.0 Ah
Engine Manufacturer	Perkins

#### ■ Environment Data

Sound power LWA, guaranteed	96.0 dB(A)
-----------------------------	------------

#### ■ Chassis

Operating pressure	6,090.0 psi
Flow rate	38.0 gal/mi

#### ■ Shipping and Storage

Shipping weight	14,267.7 lb
-----------------	-------------

Available engines

56 kW Diesel engine (Stage 5)

Cylinder capacity	135.2 Inch3
Effective power	58.3 hp
Maximum torque	147.5 lb/ft
Stroke	3.9 "
Bore	3.3 "
Cooling	Water-cooling
Engine type	Diesel engine
Cylinder	4
Fuel	Diesel EN 590
Exhaust-gas limit	EPA Tier 4 final, EU StagellIB
Engine Manufacturer	Perkins
Engine Designation	404F-E22TA

## Dimensions

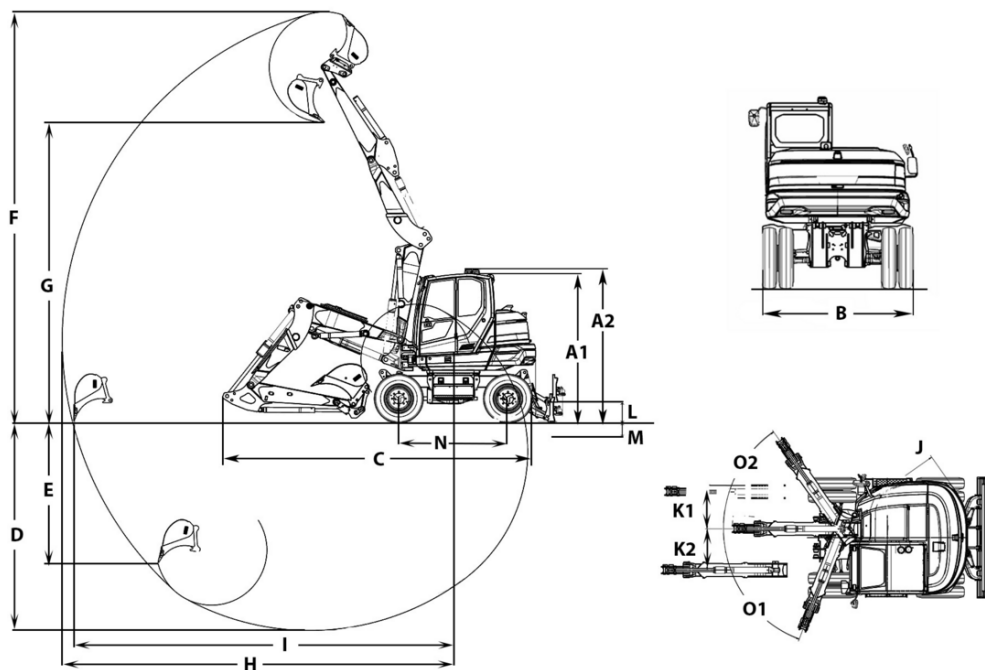

		Monobloc boom	Articulated boom
	Height of dozer blade	16.9 in	16.9 in
A2	Total height with rotating beacon	116.2 in	116.2 in
B	Width of upper carriage	76.08 in	76.08 in
	Width of cab	39.4 in	39.4 in
B	Width travel gear twin tires	81.4 in	81.4 in
	Width travel gear single tires	75.3 in	75.3 in
C	Transport length short shovel arm	238.5 in	242.6 in
	Transport length long shovel arm	243.8 in	247.6 in
D	Digging depth max., short shovel arm	137.7 in	140.2 in
	Digging depth max., long shovel arm	149.4 in	151.9 in
E	Piercing depth max., short shovel arm	81.4 in	96.1 in
	Piercing depth max., long shovel arm	92.1 in	106.7 in
F	Piercing height max., short shovel arm	236.7 in	266.5 in
	Piercing height max., long shovel arm		275.6 in
G	Dumping height max., short shovel arm	164.1 in	193.5 in
	Dumping height max., long shovel arm	171.2 in	202.6 in
H	Digging radius max., short shovel arm	242.6 in	
	Digging radius max., long shovel arm	253.7 in	268.2 in
I	Max. reach at ground level (short shovel arm)	234.9 in	249.8 in
	Max. reach at ground level (long shovel arm)	246.4 in	261.5 in
J	Tail swing radius	57.48 in	57.48 in
K1	Boom offset max. (to center of bucket right side)	29.9 in	29.9 in
K2	Boom offset max. (to center of bucket left side)	19.2 in	19.2 in
L	Stacking height max. (dozer blade above surface)	15.4 in	15.4 in
M	Digging depth max. (dozer blade below surface)	11.7 in	11.7 in
N	Length travel drive	113.75 in	113.75 in
O1	Max. swivel angle (arm system to the left)	67 °	67 °
O2	Max. swivel angle (arm system to the right)	63 °	63 °
	Track width	11.82 in	11.82 in
	Boom swing radius center	96.1 in	102.64 in
Q2	Boom swing radius right	94.28 in	99.64 in
Q3	Boom swing radius left	76.44 in	81.68 in
	Distance bucket dozer blade, short shovel arm	2 in	20.2 in
	Distance bucket dozer blade, long shovel arm	0 in	15.1 in

The illustrations, equipment and data shown may deviate from the current delivery program of your country. Optional equipment subject to additional charge may be shown. Subject to changes.