



EW65

Wheeled Excavators

for maximum flexibility in everyday work

Thanks to road transport without a flat bed truck, you can reach your job sites quickly and efficiently with the EW65. The intuitive single-pedal driving concept enables safe, comfortable driving – fast like a car. On the construction site, the EW65 impresses with its load-independent hydraulics (LUDV) for precise, smooth movements, even with parallel sequence of operations. The optional triple boom and the 3-point kinematics ensure more efficient working and reduce unnecessary movement of the machine. The result: greater productivity, lower fuel consumption, and noticeably lower operating costs.

Highlights

- 3-point kinematics
- Intuitive operating concept
- Optimal positioning of hydraulic components
- Powerful drive system with LUDV
- Triple boom

Technical Data

Hydraulic

Operating pressure hydraulics	240.0 bar
Flow rate	144.0 l/min
Tank capacity	92.0 l

Mechanical - Output Details

Nominal rotation speed	2,500.0 1/min
Travel speed	30.0 km/h

Mechanical Details

Length	6,349.0 mm
Width	2,088.0 mm
Height	2,775.0 mm
Operating weight (min.-max.)	6,755.0 - 8,647.0 kg
Digging depth (max.)	3,895.0 mm

Engine

Cooling	Water-cooling
Engine type	Diesel engine
Cylinder	4.0
Cylinder capacity	2,216.0 cm ³

Inclined position max.	30.0 °
Fuel	HVO EN15940
Effective power	45.5 KW
Nominal Engine speed	3,000.0 1/min
Operating power	45.5 KW
Operating Engine speed	3,000.0 1/min
Maximum torque	190.0 Nm
Air cleaner	Dry air filter
Battery capacity (nom. value)	88.0 Ah
Engine Manufacturer	Perkins

Environment Data

Sound power LWA, guaranteed	96.0 dB(A)
-----------------------------	------------

Chassis

Operating pressure	420.0 bar
Flow rate	144.0 l/min

Shipping and Storage

Shipping weight	6,471.7 kg
-----------------	------------

Available engines

■ 56 kW Diesel engine (Stage 5)

Cooling	Water-cooling
Engine type	Diesel engine
Cylinder	4
Cylinder capacity	2,216 cm ³
Fuel	Diesel EN 590
Effective power	43.5 KW
Nominal Engine speed	2,000 1/min
Engine speed (max. torque)	1,800 1/min
Exhaust-gas limit	EPA Tier 4 final, EU StageIIIB
Starter battery Voltage	12 µg/l
Engine Manufacturer	Perkins
Engine Designation	404F-E22TA
Stroke	100 mlai
Bore	84 mlai

Dimensions

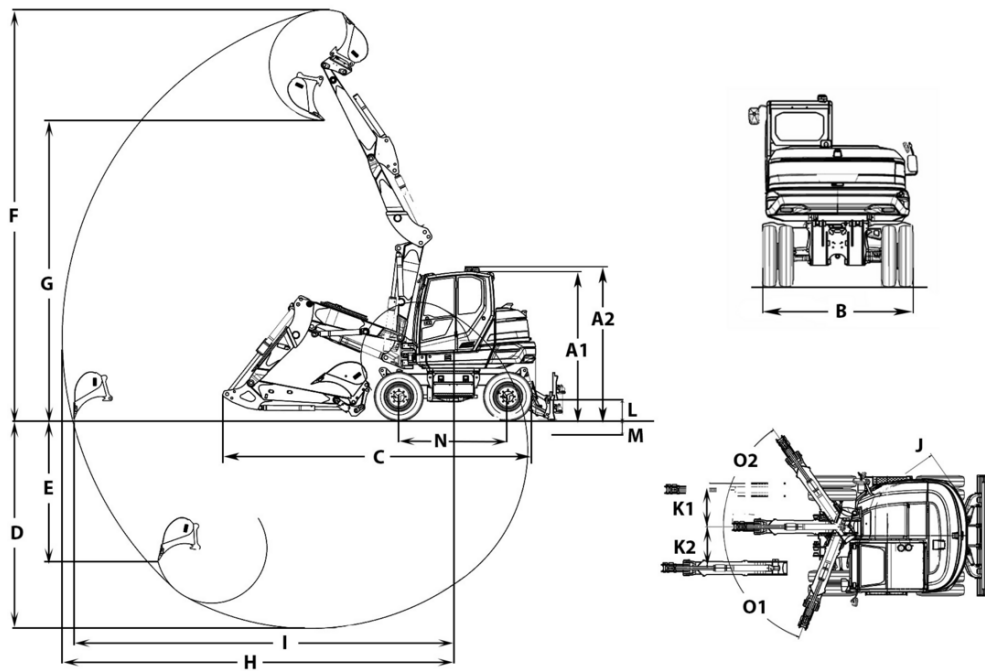

		Monobloc boom	Articulated boom
A1	Height with cab	2,775 mm	2,775 mm
	Height of dozer blade	429 mm	429 mm
A2	Total height of cabin with rotating beacon	2,952 mm	2,952 mm
B	Width of upper carriage	1,931 mm	1,931 mm
	Width of cab	1,000 mm	1,000 mm
B	Width travel gear twin tires	2,088 mm	2,088 mm
	Width travel gear single tires	1,931 mm	1,931 mm
C	Transport length short shovel arm	6,114 mm	6,220 mm
	Transport length long shovel arm	6,250 mm	6,349 mm
D	Digging depth max., short shovel arm	3,531 mm	3,596 mm
	Digging depth max., long shovel arm	3,831 mm	3,895 mm
E	Piercing depth max., short shovel arm	2,088 mm	2,465 mm
	Piercing depth max., long shovel arm	2,361 mm	2,737 mm
F	Piercing height max., short shovel arm	6,068 mm	6,834 mm
	Piercing height max., long shovel arm		7,067 mm
G	Dumping height max., short shovel arm	4,207 mm	4,961 mm
	Dumping height max., long shovel arm	4,389 mm	5,195 mm
H	Digging radius max., short shovel arm	6,220 mm	6,590 mm
	Digging radius max., long shovel arm	6,504 mm	6,877 mm
I	Max. reach at ground level (short shovel arm)	6,024 mm	6,406 mm
	Max. reach at ground level (long shovel arm)	6,318 mm	6,706 mm
J	Tail swing radius	1,459 mm	1,459 mm
K1	Boom offset max. (to center of bucket right side)	766 mm	766 mm
K2	Boom offset max. (to center of bucket left side)	492 mm	492 mm
L	Stacking height max. (dozer blade above surface)	395 mm	395 mm
M	Digging depth max. (dozer blade below surface)	301 mm	301 mm
N	Length travel drive	2,887 mm	2,887 mm
O1	Max. swivel angle (arm system to the left)	67 °	67 °
O2	Max. swivel angle (arm system to the right)	63 °	63 °
	Track width	300 mm	300 mm
	Boom swing radius center	2,465 mm	2,605 mm
Q2	Boom swing radius right	2,393 mm	2,529 mm
Q3	Boom swing radius left	1,940 mm	2,073 mm
	Distance bucket dozer blade, short shovel arm	51 mm	514 mm
	Distance bucket dozer blade, long shovel arm	0 mm	384 mm

The illustrations, equipment and data shown may deviate from the current delivery program of your country. Optional equipment subject to additional charge may be shown. Subject to changes.