



DT12

Track Dumper

Works efficiently everywhere

The hydraulically activated and pilot-operated machine provides for overall simple operation, and the hydrostatic drive system make it a comfortable and durable machine for a variety of job site applications. Rubber tracks provide excellent weight distribution and low ground pressure even with a high payload. The extensive selection of skips, a low center of gravity and the suspension-mounted rollers make it an ideal material handler on all types of terrain.

Highlights

- Hydrostatic drive
- Small dimensions
- Plastic skip

Technical Data

■ Mechanical - Output Details

Gradeability	62.0 %
Travel speed	2.6 m/H
Travel speed (Option)	5.6 m/H

■ Mechanical Details

Length	81.6 "
Width	31.1 "
Height	51.3 "
Weight	1,653.47 lb

Payload max.	2,645.5 lb
Skip	Swivel skip
Skip capacity levelled	0.5 yd3
Skip capacity heaped	0.7 yd3

■ Engine

Engine type	Gasoline engine
Effective power	23.1 hp
Nominal Engine speed	3,600.0 1/min

Dimensions

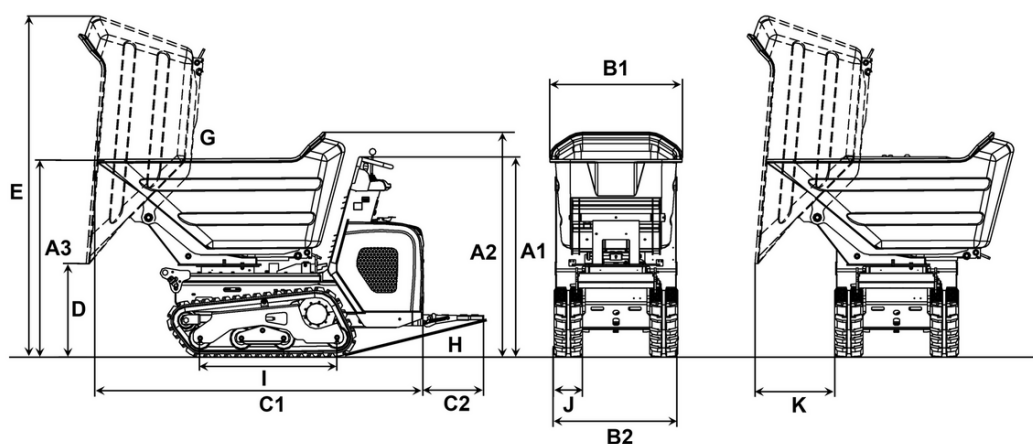

		Front tip skip	High tip skip	Swivel tip skip	Front tip skip platform	Plastic skip
A1	Height above operator's stand	50.4 in	50.4 in	50.4 in	50.4 in	
A2	Height over skip hand guard					56.6 in
B1	Width of skip	32.7 in	32.7 in	30.8 in	31.5 in	33.3 in
B2	Width of undercarriage	31.1 in	31.1 in	31.1 in	31.1 in	31.1 in
C1	Total length without footboard	71.8 in	68.3 in	77.2 in	74.1 in	81.6 in
C2	Length footboard	15.3 in	15.3 in	15.3 in	15.3 in	15.3 in
C3	Length with self-loading equipment, without footboard	89.6 in				
D	Dumping height max.	18.1 in	32.0 in		10.1 in	23.5 in
	Dumping height max., high tip skip raised		55.8 in			
E	Skip height tilted	76.8 in	82.7 in	84.8 in	56.3 in	85.8 in
	Skip height tilted, high tip skip raised		106.7 in			
G	Dumping angle	70 °	83 °	85 °	56 °	85 °
H	Rollback angle footboard	14 °	14 °	14 °	14 °	14 °
I	Length chain stand	34.5 in	34.5 in	34.5 in	34.5 in	34.5 in
J	Track width	7.1 in	7.1 in	7.1 in	7.1 in	7.1 in
K	Dumping width lateral			19.2 in		