



## ET58

### Tracked Conventional Excavator

Powerful, comfortable and safer

Full speed ahead: The ET58 mini excavator combines proven technology with a large dose of innovation to become a champion in the 5-6-metric-ton class. It has the usual high lifting and digging forces as well as fast work cycles. Thanks to the latest technologies, emissions have been reduced and efficiency has been increased at the same time. The powerful engine meets the Stage 5 emission standards. The excavator also makes an impression in terms of user-friendliness. Work is easy and comfortable due to the intuitive operating concept and the excellent view of the working area.

### Highlights

- Flexible cylinder rod protection
- 3-point kinematics
- Active Working Signal (AWS)
- Up to 5 additional control circuits ex work
- Load Sensing Flow Sharing

### Technical Data

#### Hydraulic

Operating pressure hydraulics	3,552.5 psi
Hydraulic pump	Axial piston pump
Flow rate	33.3 gal/mi
Flow rate max.	34.9 gal/mi

#### Mechanical - Output Details

Travel speed	2.7 m/H
--------------	---------

#### Mechanical Details

Length	238.2 "
Width	77.2 "
Height	105.0 "
Weight	10,178.75 lb
Operating weight (min.-max.)	11,137.8 - 14,078.7 lb
Digging depth (max.)	158.1 "

#### Engine

Cooling	Water-cooling
Engine type	Diesel engine

Cylinder	3.0
Cylinder capacity	101.4 Inch <sup>3</sup>
Inclined position max.	30.0 °
Fuel	HVO EN15940
Effective power	44.9 hp
Nominal Engine speed	2,100.0 1/min
Exhaust-gas limit	EU Stage V
Battery capacity (nom. value)	77.0 Ah
Engine Manufacturer	Perkins
Engine Designation	403J-E17T

#### Environment Data

Sound power LWA, guaranteed	97.0 dB(A)
-----------------------------	------------

#### Chassis

Traction drive	Axial piston motor with RGU
----------------	-----------------------------

#### Shipping and Storage

Shipping weight	10,619.7 lb
-----------------	-------------

## Dimensions

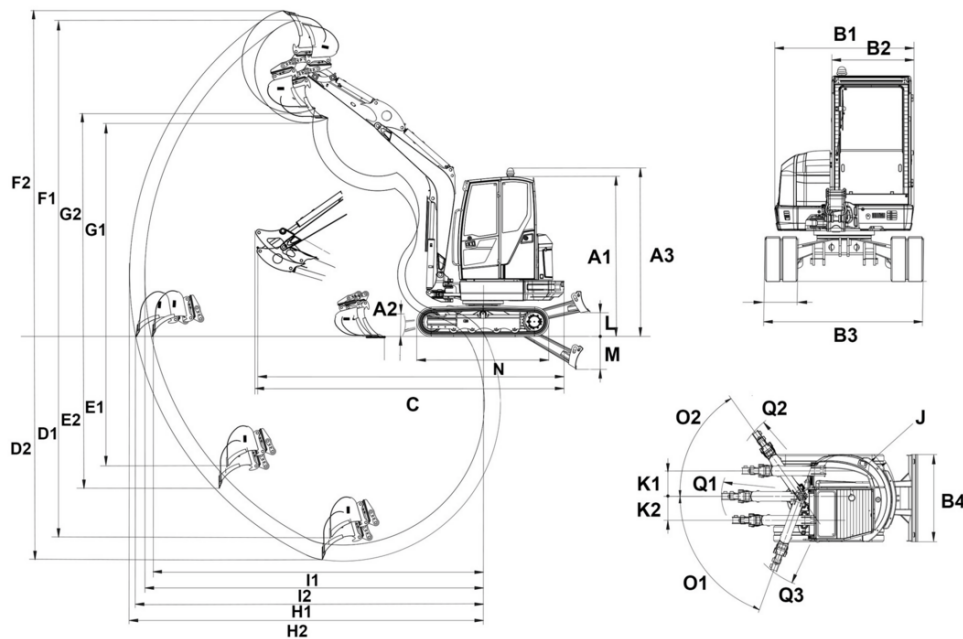

		Standard dozer blade	Swiveling dozer blade
A1	Height with cab	100.47 in	100.47 in
A2	Height of dozer blade	16.9 in	
A3	Total height with rotating beacon	104.84 in	104.84 in
B1	Width of upper carriage	67.73 in	67.73 in
B2	Width of cab	38.61 in	38.61 in
B3	Width travel gear	77.22 in	77.22 in
B4	Width of dozer blade	77.22 in	77.22 in
C	Transport length short shovel arm	214.93 in	214.93 in
	Transport length long shovel arm	214.57 in	214.57 in
D1	Digging depth max., short shovel arm	148.42 in	148.42 in
D2	Digging depth max., long shovel arm	158.27 in	158.27 in
E1	Piercing depth max., short shovel arm	106.7 in	106.7 in
E2	Piercing depth max., long shovel arm	116.03 in	116.03 in
F1	Piercing height max., short shovel arm	226.51 in	226.51 in
F2	Piercing height max., long shovel arm	232.85 in	232.85 in
G1	Dumping height max., short shovel arm	151.06 in	151.06 in
G2	Dumping height max., long shovel arm	157.4 in	157.4 in
H1	Digging radius max., short shovel arm	237.94 in	237.94 in
H2	Digging radius max., long shovel arm	247.31 in	247.31 in
I1	Max. reach at ground level (short shovel arm)	233.25 in	233.25 in
I2	Max. reach at ground level (long shovel arm)	242.86 in	242.86 in
J	Tail swing radius	51.7 in	
	Tail swing radius with tail weight	55.8 in	
K1	Boom offset max. (to center of bucket right side)	21.71 in	21.71 in
K2	Boom offset max. (to center of bucket left side)	22.97 in	22.97 in
L	Stacking height max. (dozer blade above surface)	16.31 in	18.16 in
M	Digging depth max. (dozer blade below surface)	17.3 in	19.15 in
N	Length travel drive	98.85 in	98.85 in
O1	Max. swivel angle (arm system to the left)	70 °	70 °
O2	Max. swivel angle (arm system to the right)	55 °	55 °
Q1	Boom swing radius center	94.91 in	94.91 in
Q2	Boom swing radius right	89.64 in	89.64 in
Q3	Boom swing radius left	79.67 in	79.67 in

The illustrations, equipment and data shown may deviate from the current delivery program of your country. Optional equipment subject to additional charge may be shown. Subject to changes.